

CORNING

Evolv™ 8-Port BPEO S1 Closure with Pushlok™ Technology Evolv 12-Port BPEO S1.5 Closure with Pushlok Technology

009-241-AEN, Issue 1

related literature | Search www.corning.com/opcomm. Click on "Resources/Standard Recommended Procedures."

[009-240-AEN](#) [Evolv™ 4-Port and 8-Port BPEO S0 Closure with Pushlok™ Technology](#)

[009-239-AEN](#) [Evolv™ ECAM Converter with Pushlok™ Technology for ROC](#)

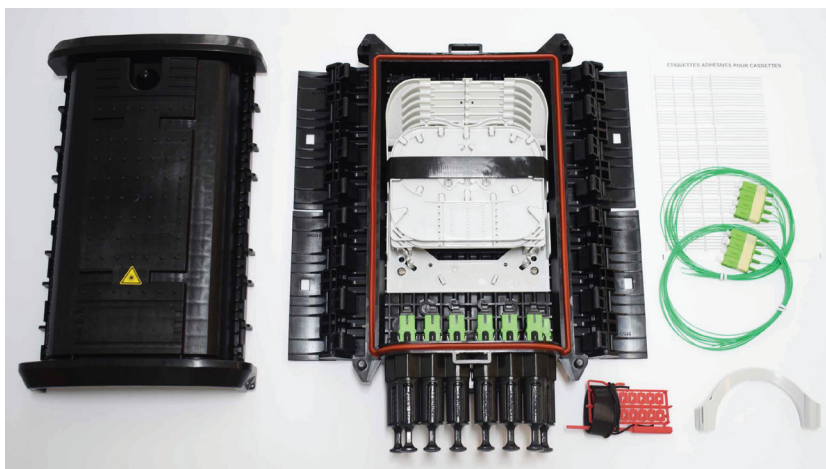

Evolv™ 8-Port BPEO S1 Closure with Pushlok™ Technology

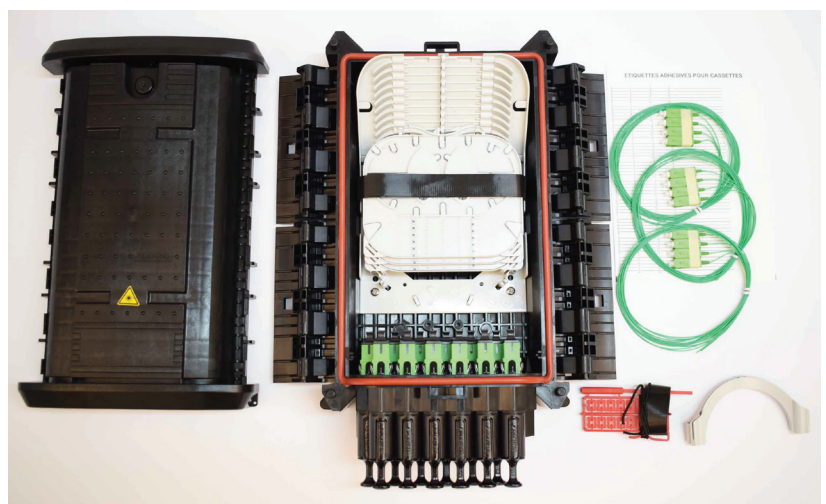

Evolv™ 12-Port BPEO S1.5 Closure with Pushlok™ Technology

Table of Contents

1.	General.....	2
2.	Recommended Tools and Accessories (not included).....	2
3.	Fixing	3
	3.1 Wall mount or manhole.....	3
	3.2 Pole.....	3
4.	Opening	4
5.	Main Distribution Cable : D18 or S12 (not supplied).....	5
	5.1 Cable Preparation	5
	5.2 ECAM D18 Installation: Uncut Cable-Midspan.....	5
	5.3 ECAM S12 Installation: Network End	7
6.	Fiber Routing.....	8
	6.1 Fiber Routing in the Organizer	8
	6.2 Fiber Routing in the Trays.....	9
7.	Secondary Distribution Cable : S9,5 or S18 (not supplied).....	10
	7.1 Cable Preparation.....	10
	7.2 ECAM S9,5 Installation.....	10
	7.3 ECAM S18 Installation (BPEO S1,5 only).....	11
8.	ECAM connect Drop Cables and ECAM Connect Filed Assembly Kits	12
9.	Other Functions.....	13
	9.1 Assembly of Splicing Tray.....	13
	9.2 Assembly of the Bridge.....	13
	9.3 Splicing Tray Identification	14
10.	Evolv™ ECAM Converter with Pushlok™ Technology Installation.....	14
11.	Closing.....	15
12.	Securing the Cover.....	15
13.	Flash Test	16

1. General

These installation instructions are provided as guidance for the trained craftsperson carrying out the installation.

2. Recommended Tools and Accessories (not included)

- Flat-tip screwdriver
- Nosed and universal pliers
- Suitable dowels and screws
- Steel band
- Pressure tool kit
- Leak detection fluid

3. Fixing

3.1 Wall Mount or Manhole

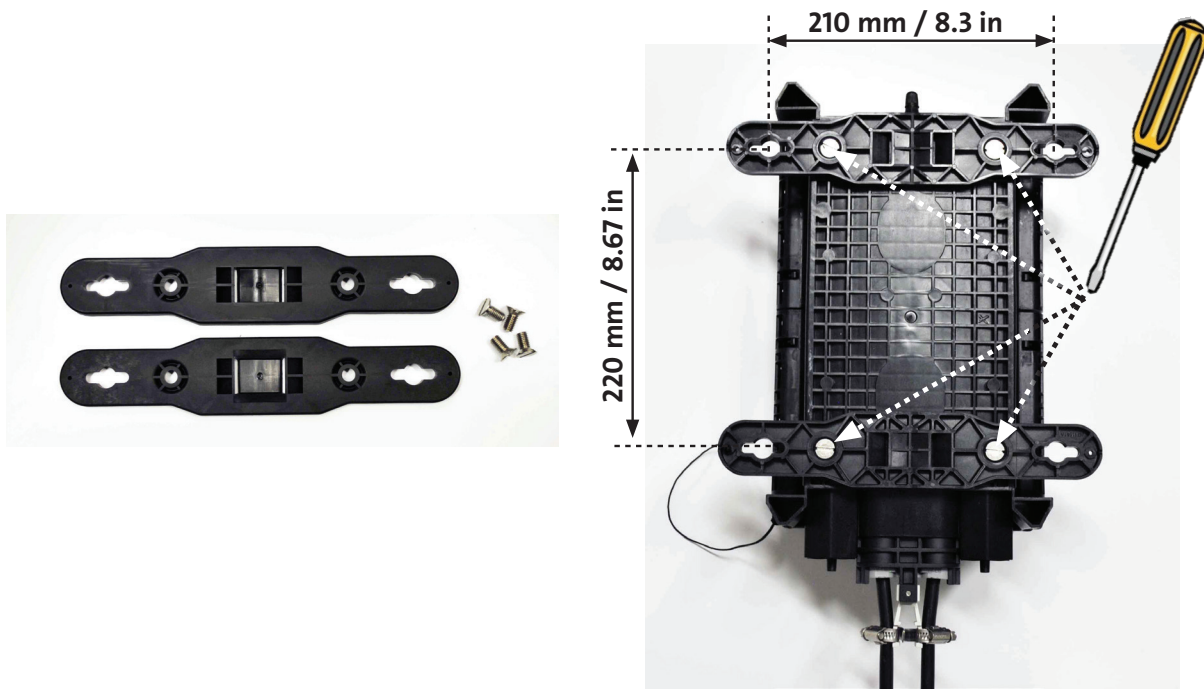

Step 1: Screw the mounting bars to the back of the BPEO and fix on the wall (distances indicated).

3.2 Pole

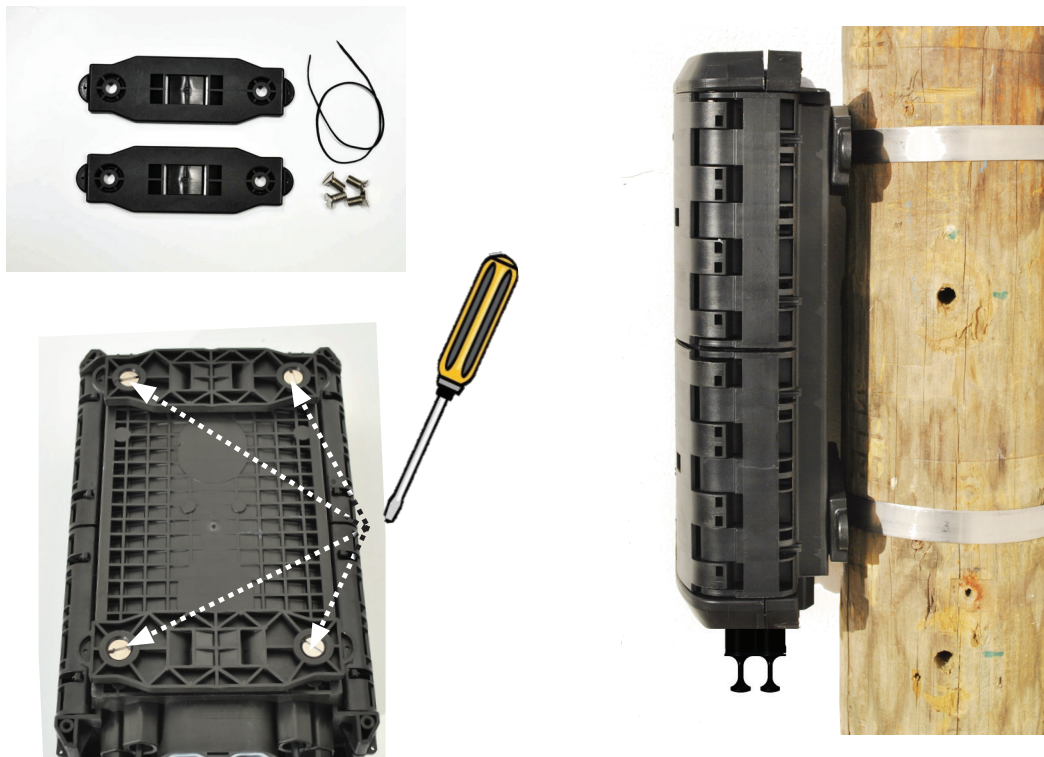

Step 1: Screw the mounting bars to the back of the BPEO and fix on the pole with metal band.

4. Opening

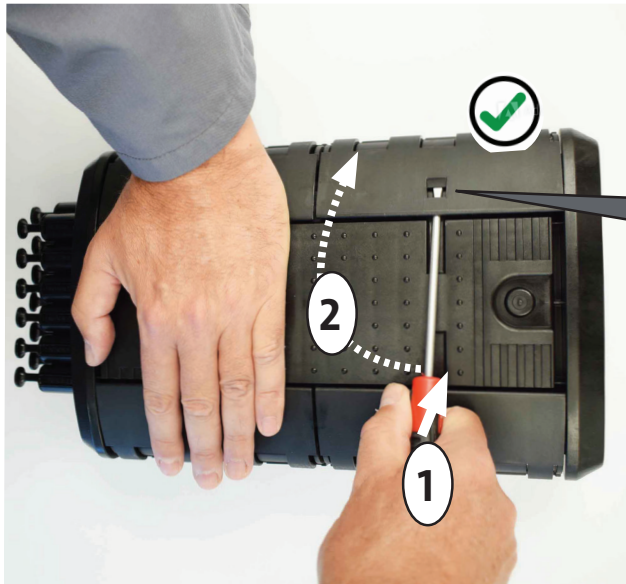

Step 1: Insert (1) and lever the screwdriver (2).



Do not introduce the screwdriver too deeply

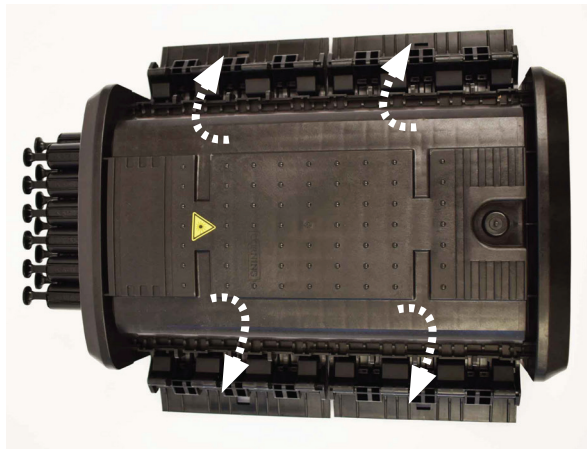

Step 2: Repeat 1 and 2 to open all latching.

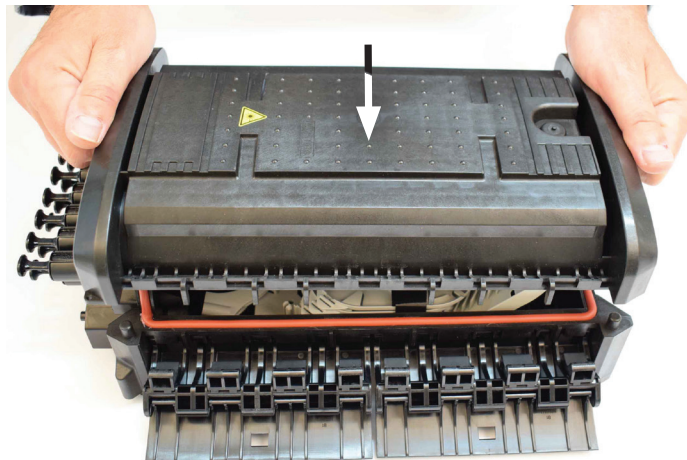

Step 3: Extract the cover.

5. Main Distribution Cable: D18 or S12 (not supplied)

5.1 Cable Preparation

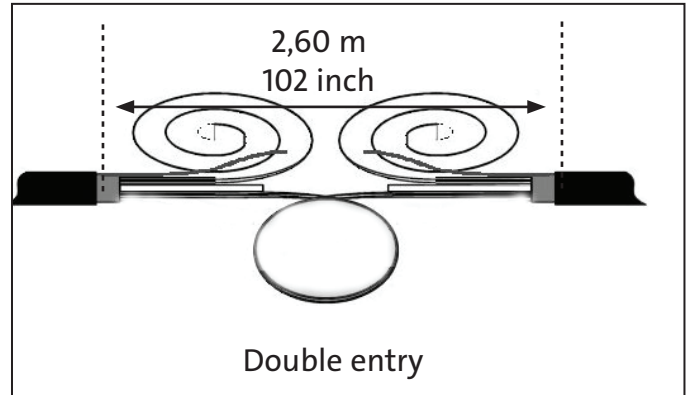
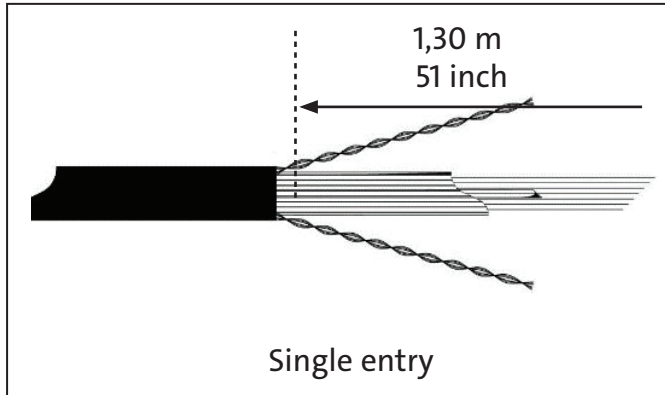

5.2 ECAM D18 Installation: Uncut Cable - Midspan

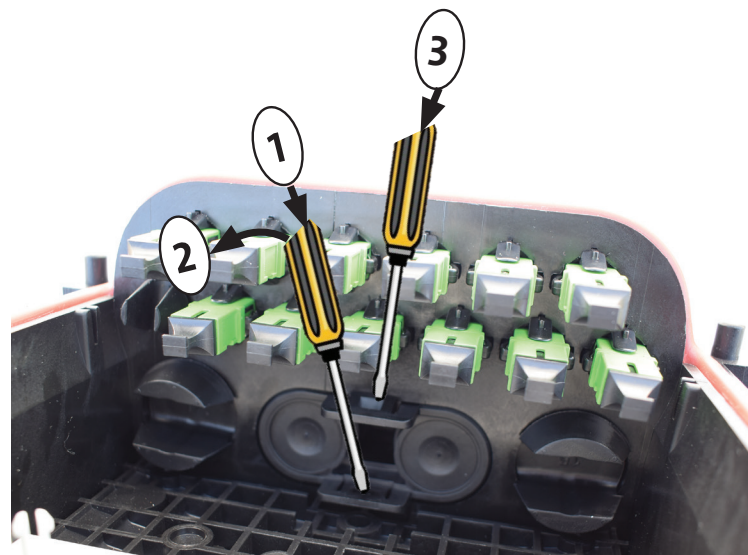

Step 1: Unlock the two latches of the sealing plug.

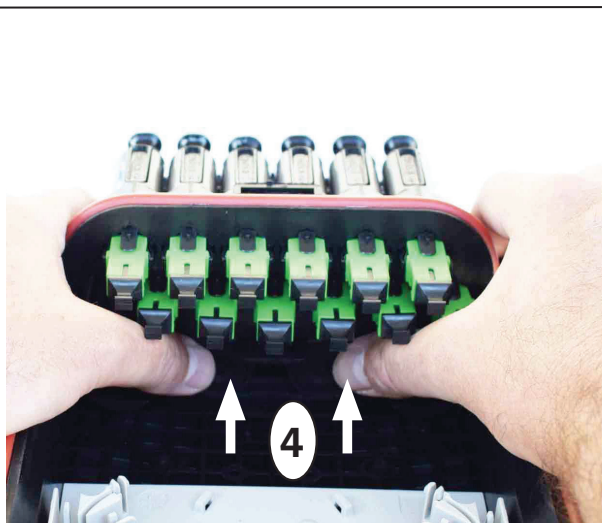

Step 2: Push the sealing plug.

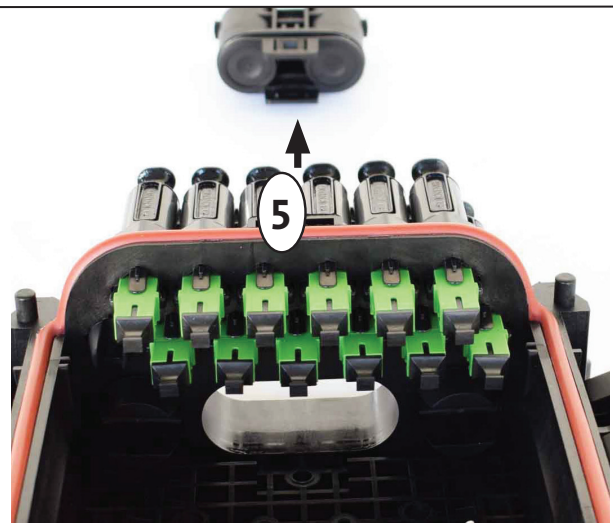

Step 3: Extract the sealing plug.

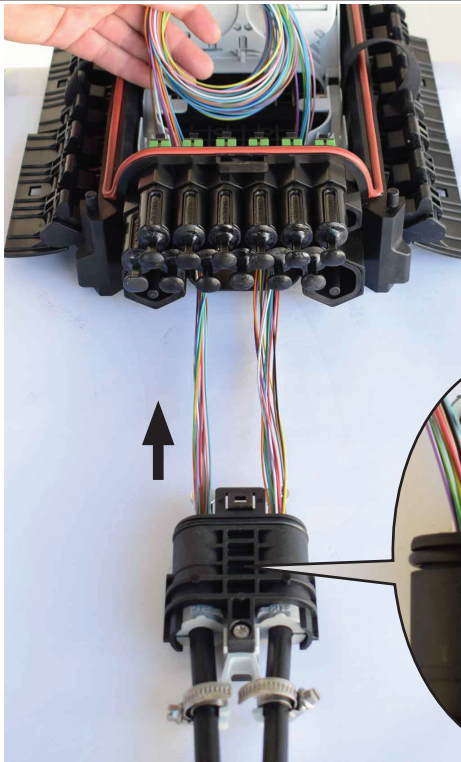

Step 4: Insert the micro-modules.

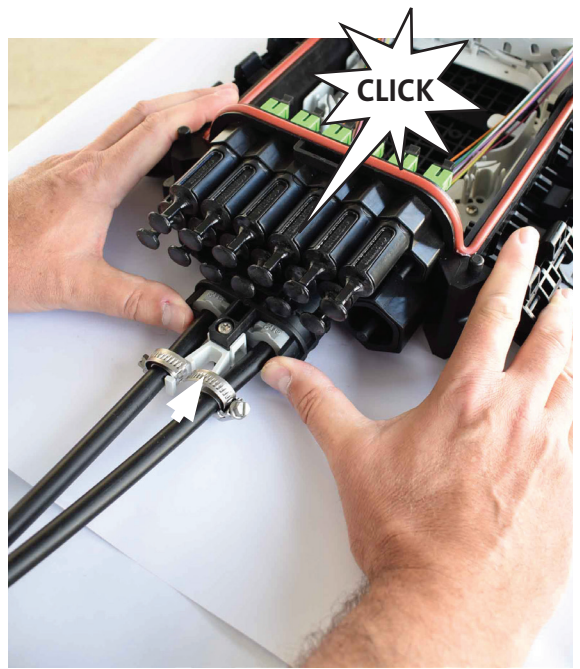

Step 5: Push and clip the ECAM D18.

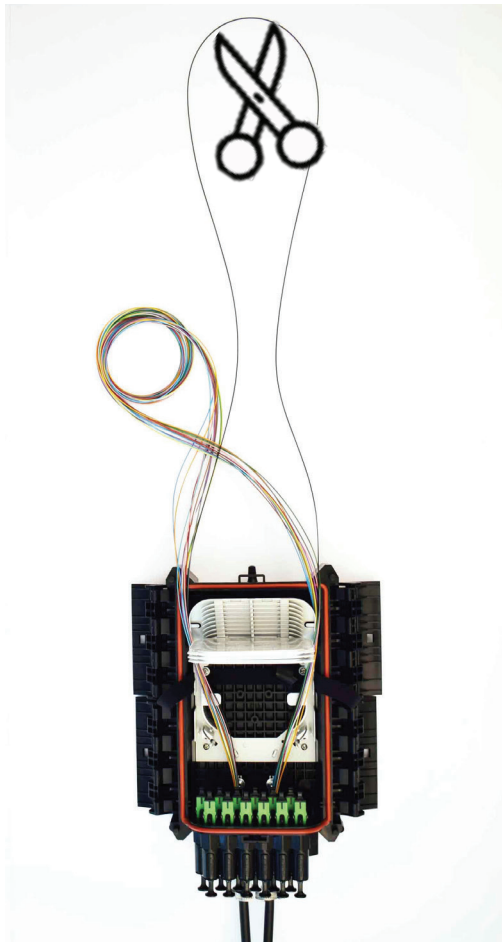

Step 6: Cut the used micro-module at the middle.

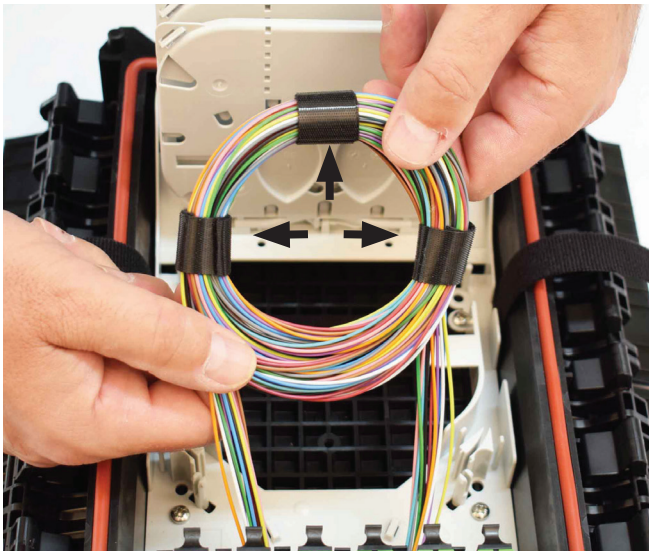

Step 7: Coil and maintain the uncut micro-modules.

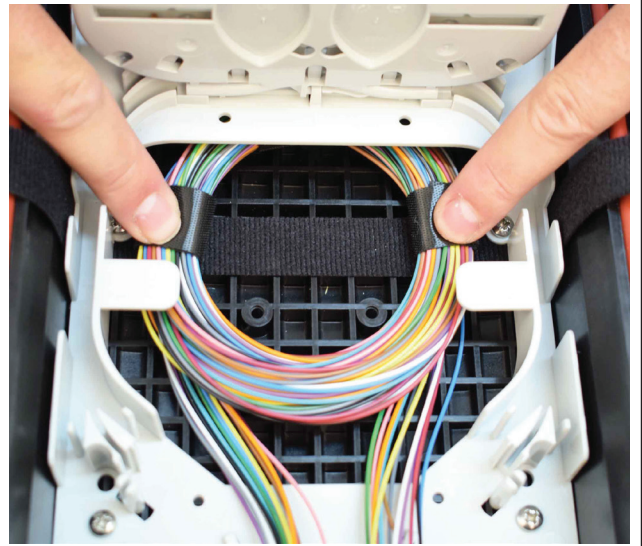

Step 8: Place and selfgrip the uncut micro-modules.

5.3 ECAM S12 Installation: Network End

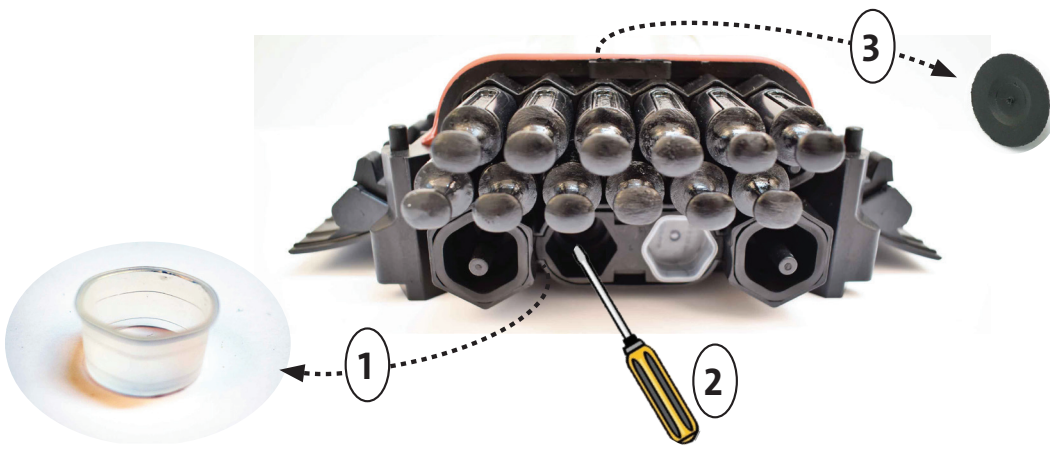

Step 1: Remove the cap (1) and break through (2)(3).

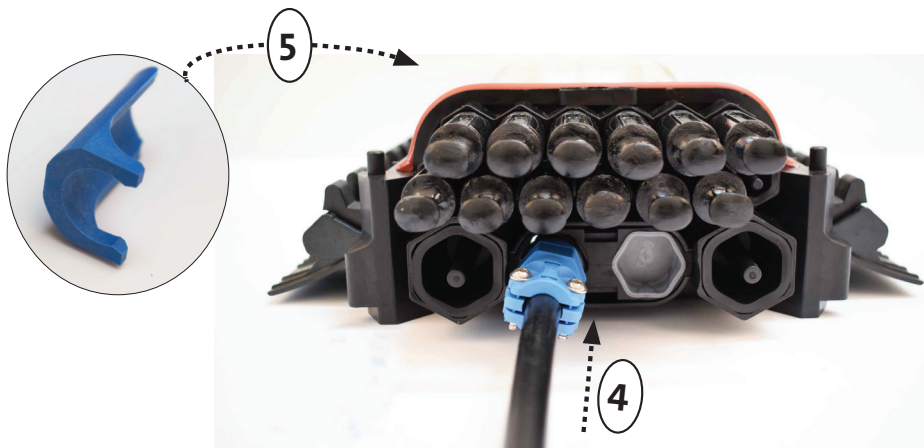

Step 2: Insert the ECAM S12 (4) and secure with the fork (5)

6. Fiber Routing

6.1 Fiber Routing in the Organizer

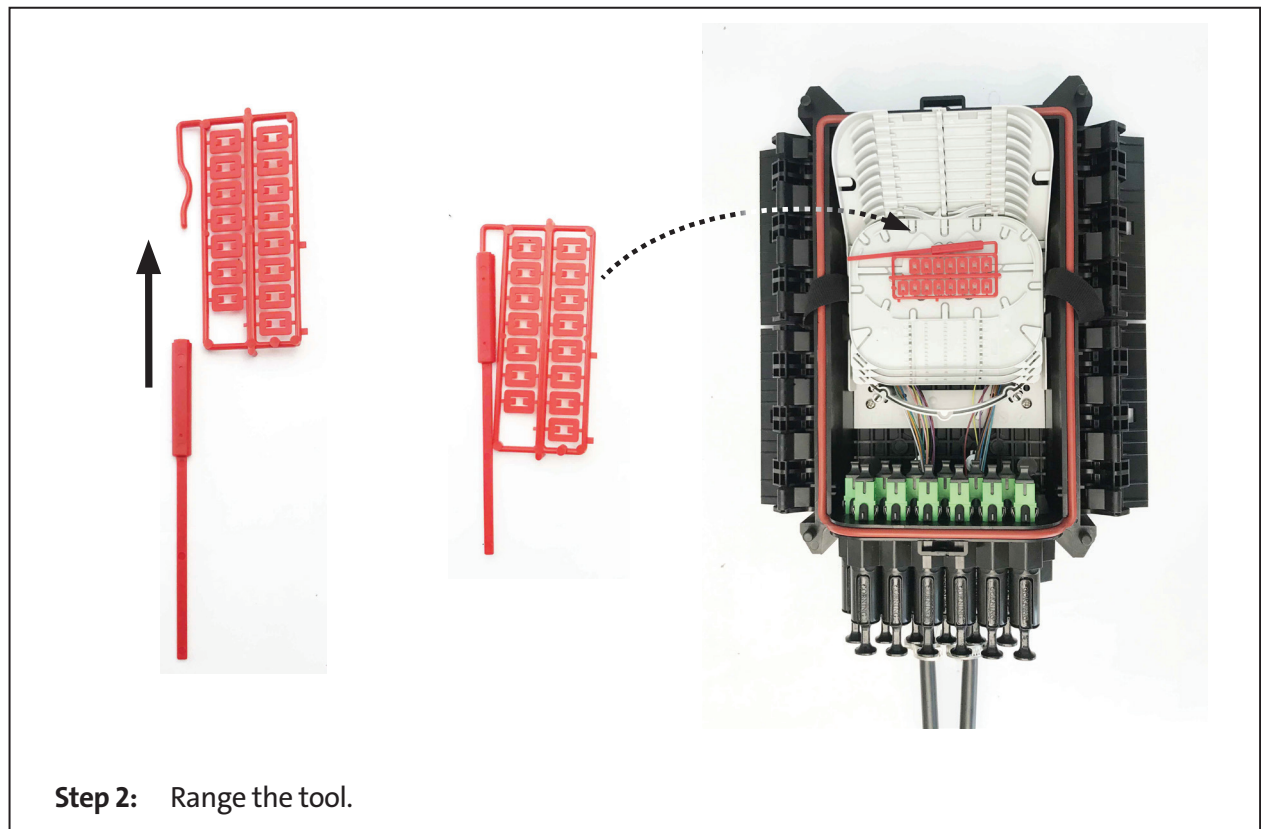
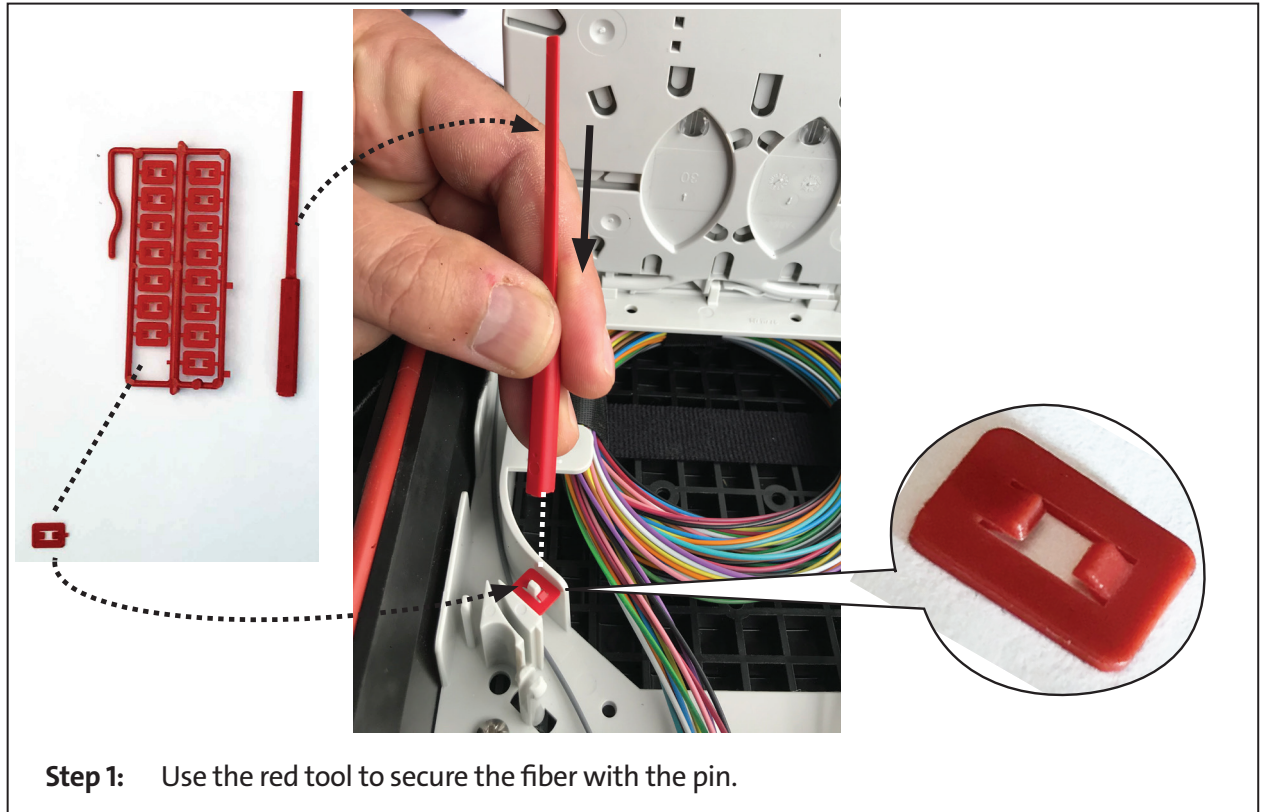

6.2 Fiber Routing in the Trays

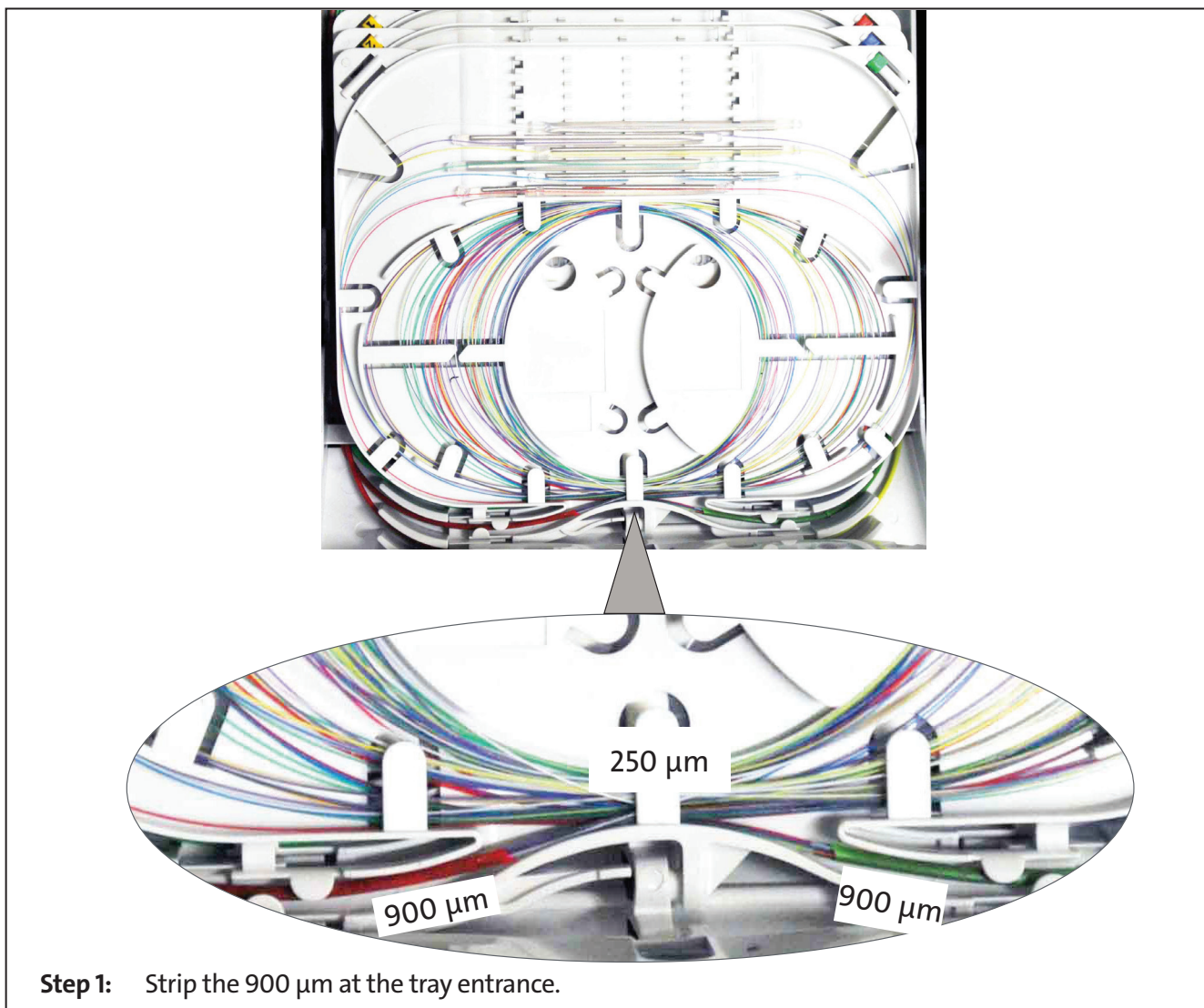
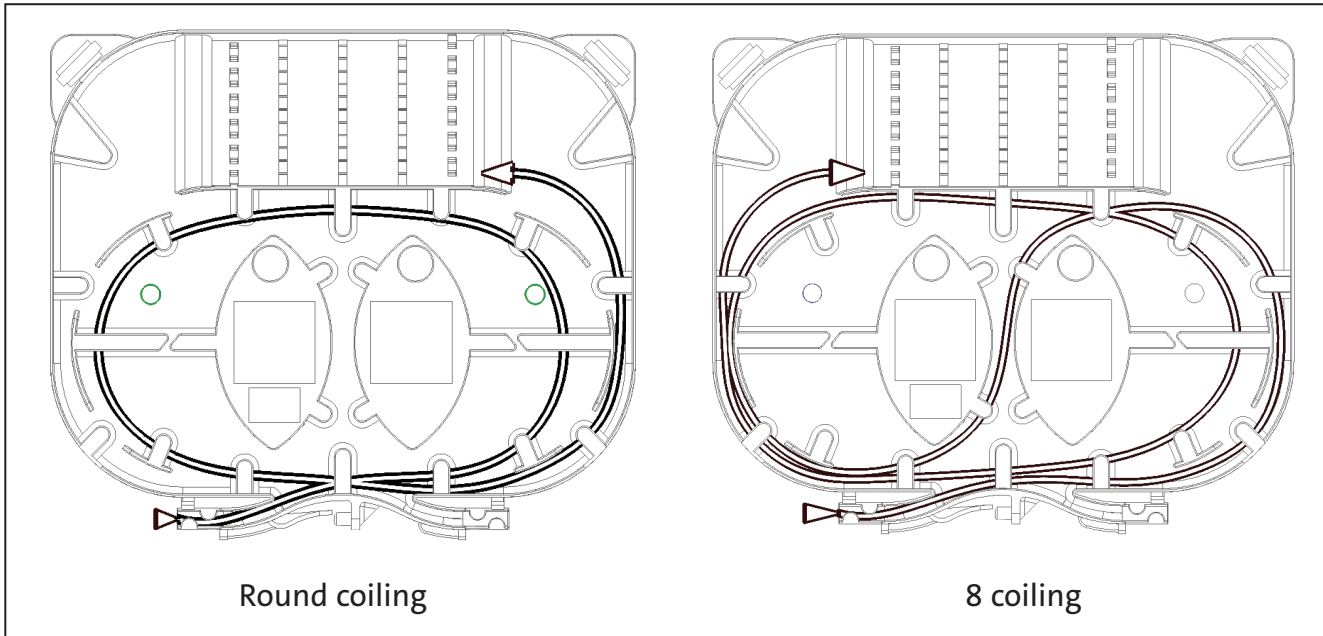

7. Secondary Distribution Cable : S9,5 or S18 (not supplied)

7.1 Cable Preparation

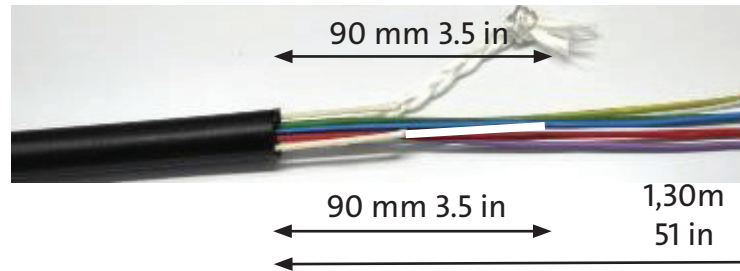

7.2 ECAM S9,5 Installation



Step 1: Extract the cap.

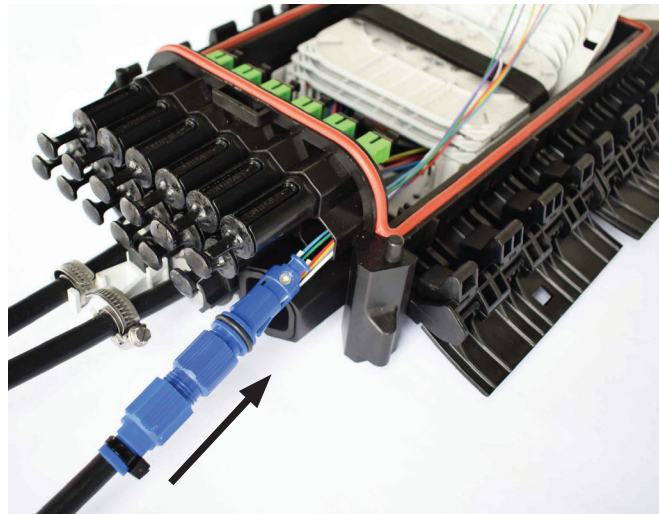

Step 2: Insert the ECAM S9,5.

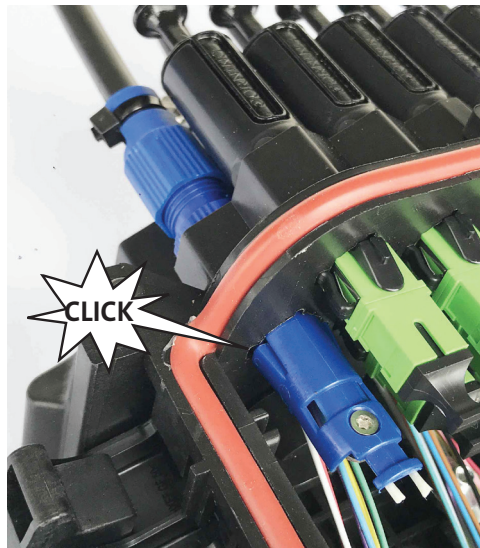

Step 3: Push and clip the ECAM S9,5

7.3 ECAM S18 Installation (BPEO S1,5 only)

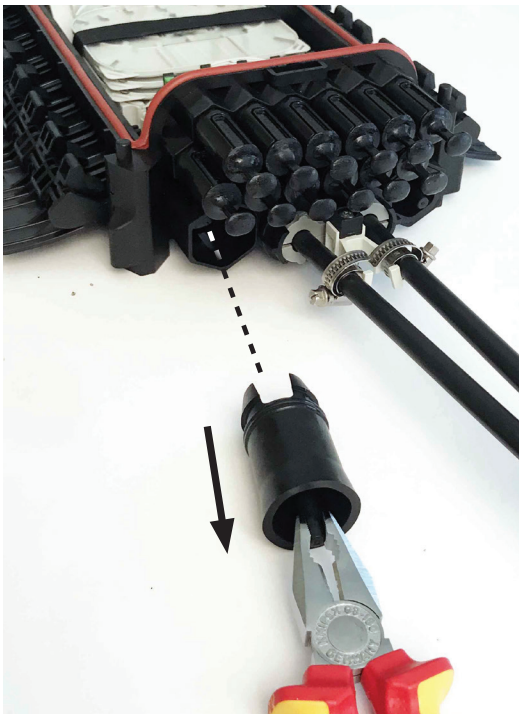

Step 1: Remove the cap.

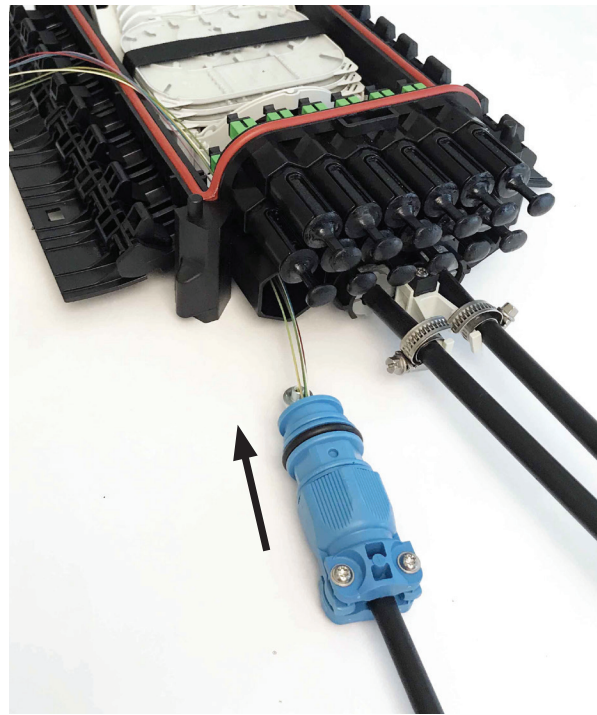

Step 2: Insert the ECAM.

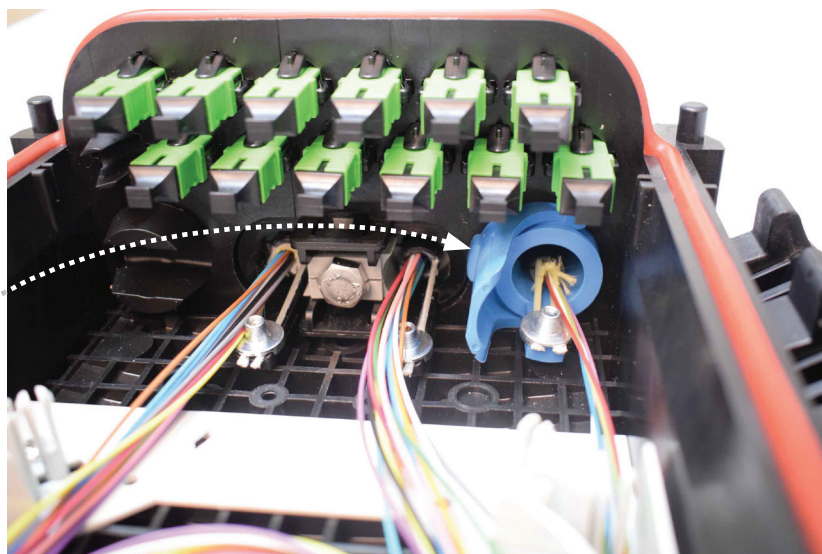

Step 3: Secure with the fork.

8. ECAM Connect Drop Cables and ECAM Connect Filed Assembly Kits



Evolv™ 8-Port BPEO S1 Closure with Pushlok™ technology

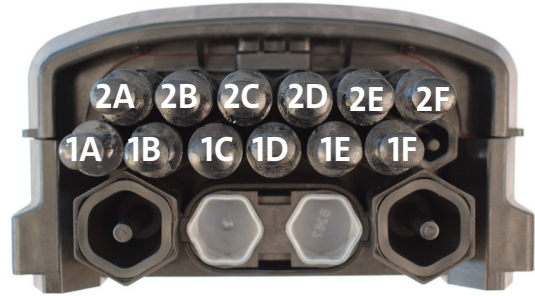

Evolv™ 12-Port BPEO S1.5 Closure with Pushlok™ technology

Step 1: Manage of the pigtails in the closure.

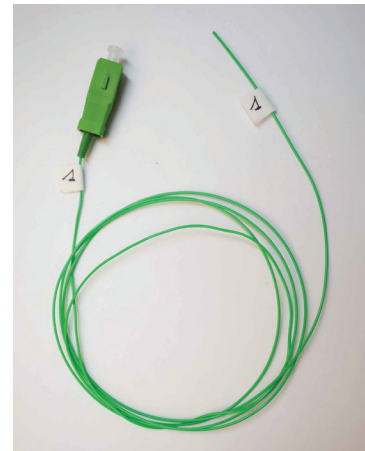

Step 2: Use the blank label template.

Step 3: Tag both ends of each pigtail.

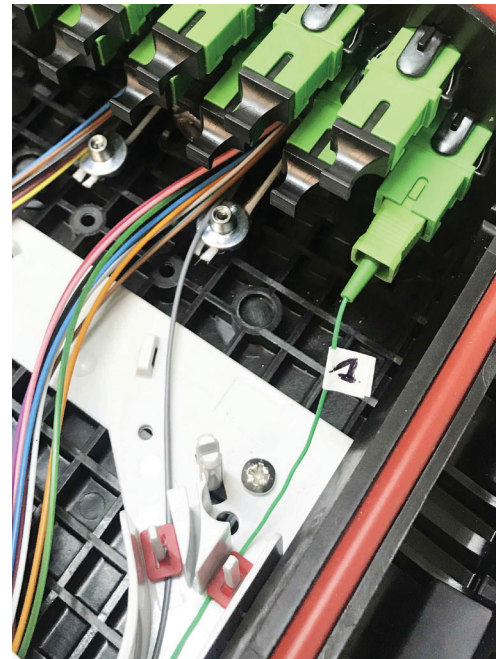
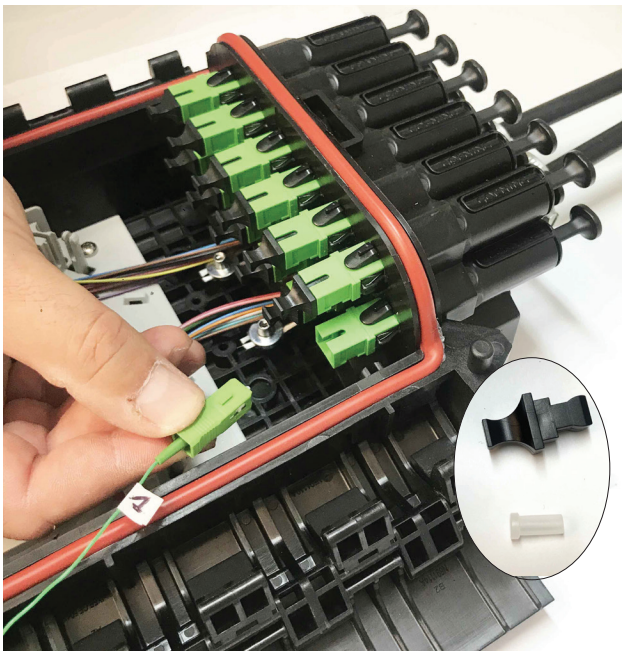

Step 4: Remove the two caps and insert the pigtail.

9. Other Functions

9.1 Assemble a Splice Tray

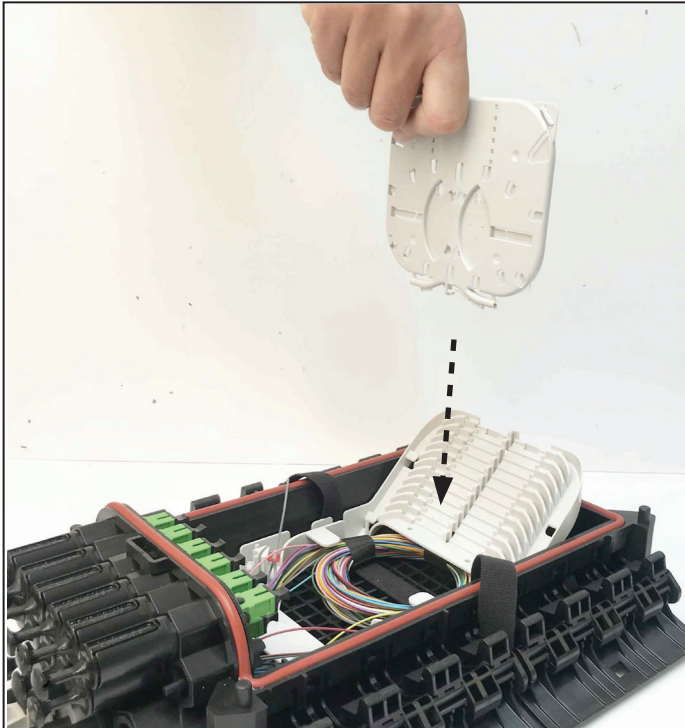

Step 1: Vertically insert the tray.

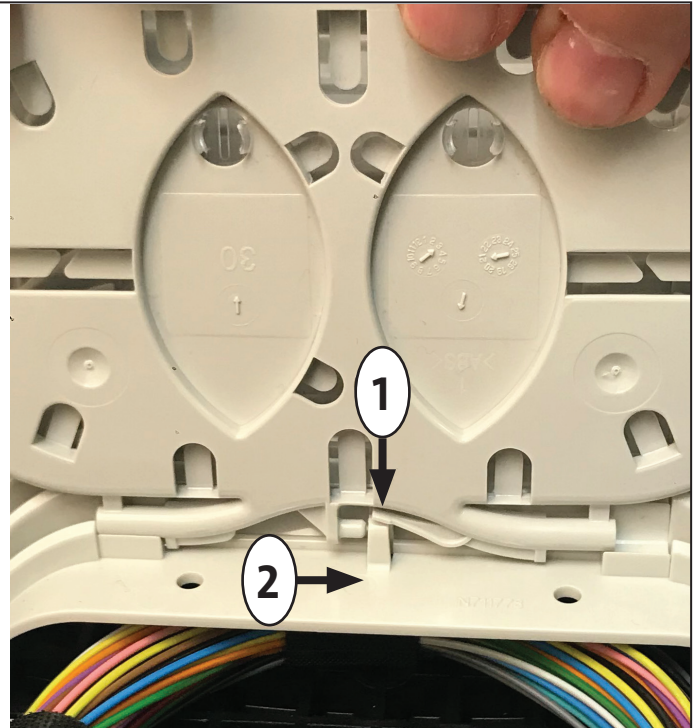

Step 2: Push (1) and insert (2).

9.2 Assembly of the Bridge

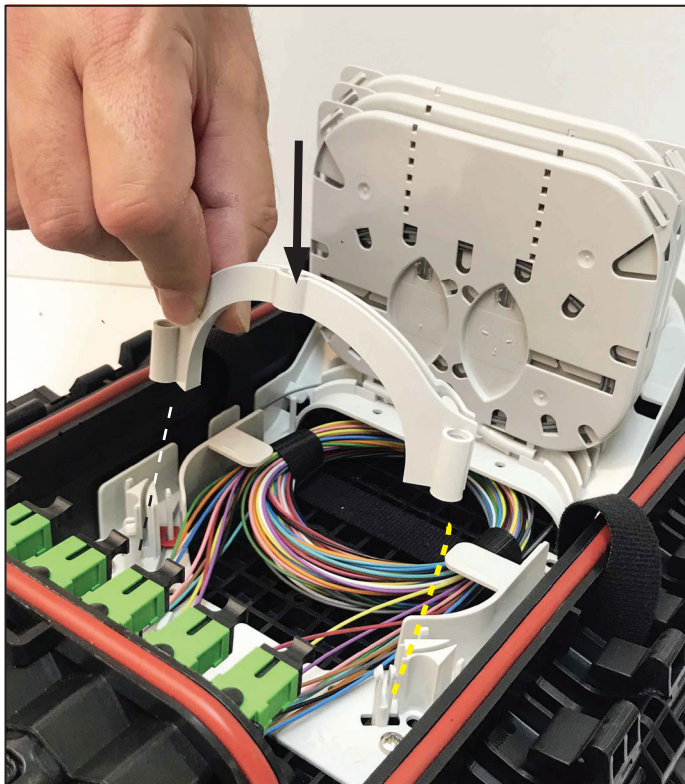

Step 1: Place the bridge.

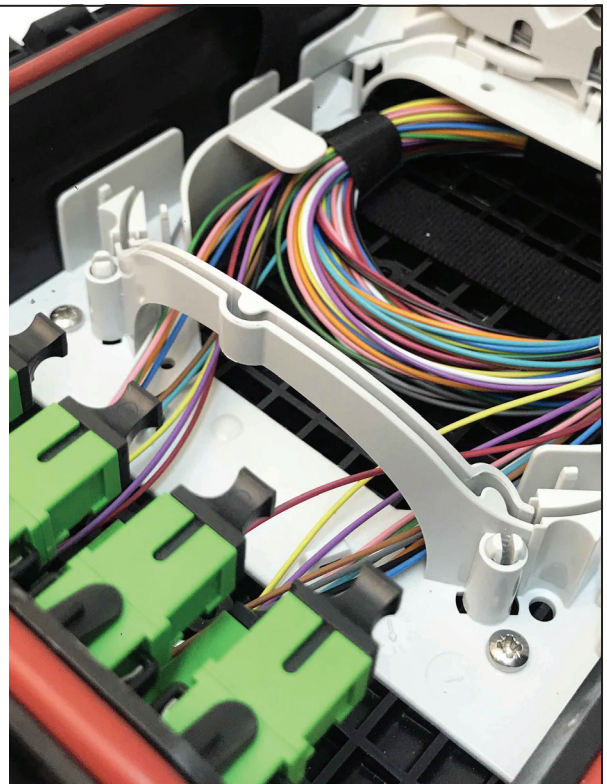

Step 2: Clip the bridge.

9.3 Splicing Tray Identification

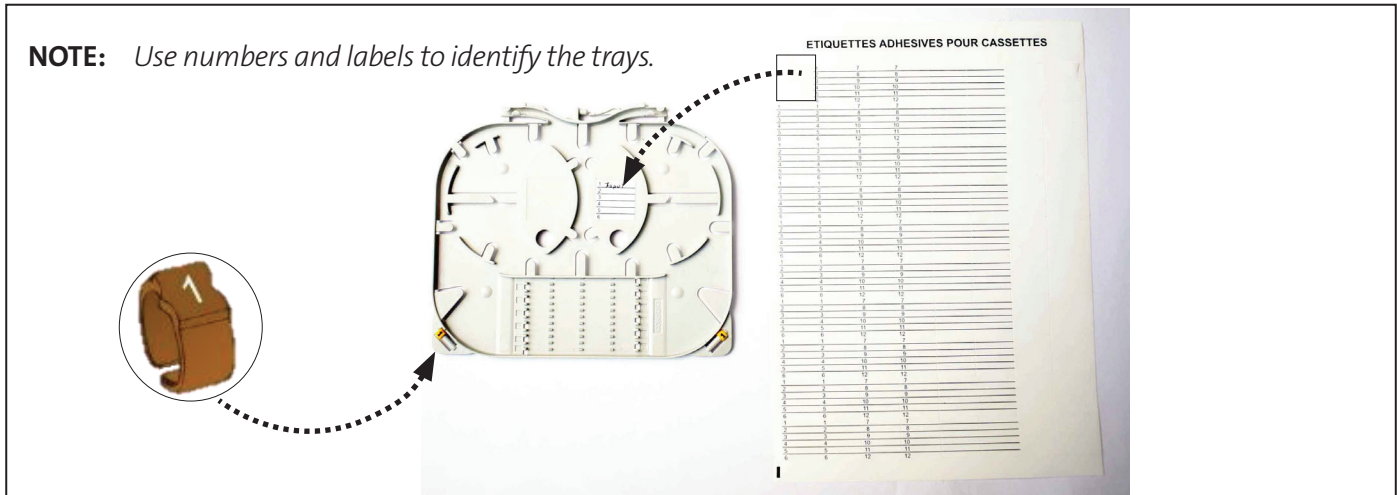

10. Use Evolv™ ECAM Converter with Pushlok™ Technology Installation

IMPORTANT: To ensure proper sealing and pull out force, make sure to assemble the converter first over the drop cable connector before plugging it into the closure port. Refer to the installation instruction delivered with the Evolv™ ECAM Converter with Pushlok™ Technology.

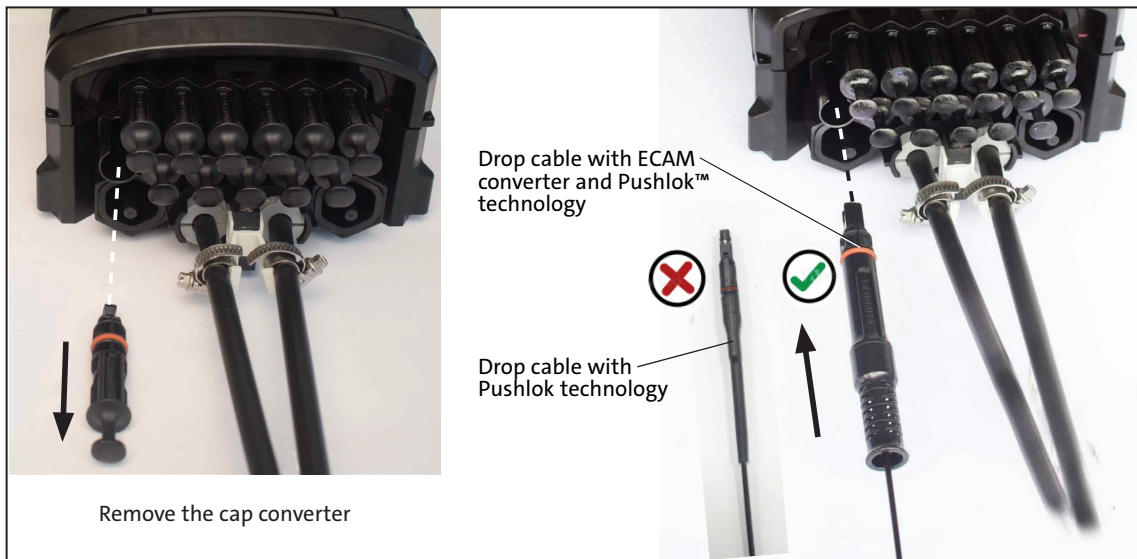
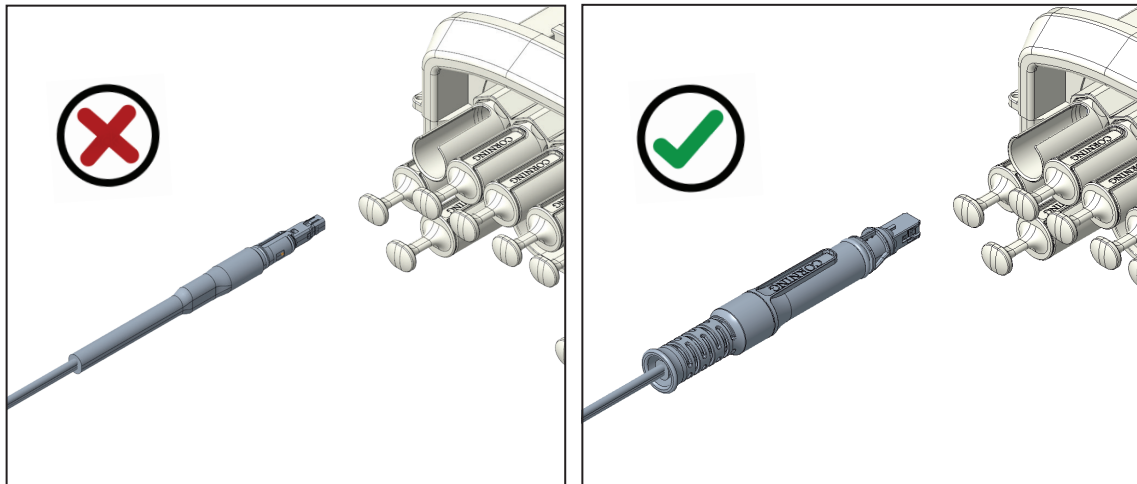

11. Closing

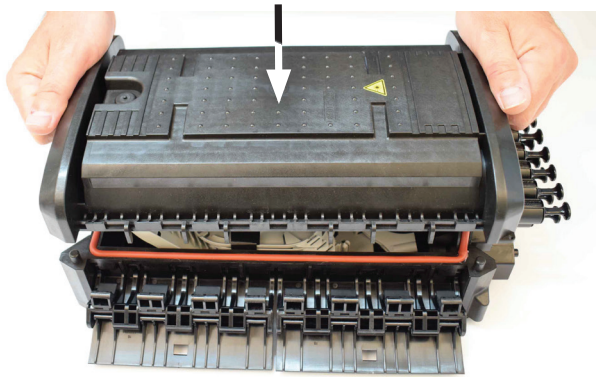

Step 1: Place the cover.

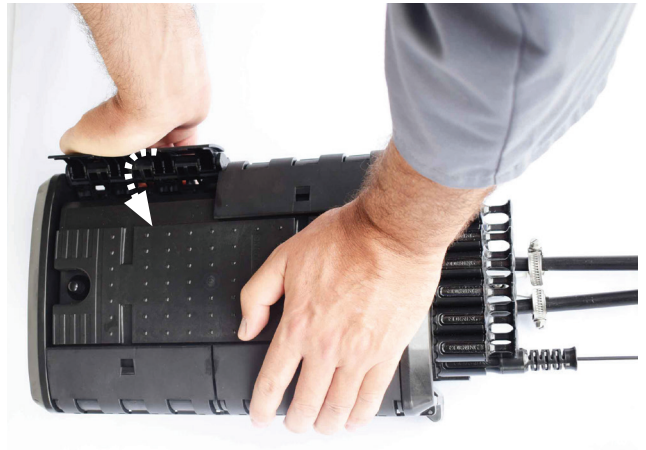

Step 2: Lift and secure the 4 latches.

12. Securing the Cover

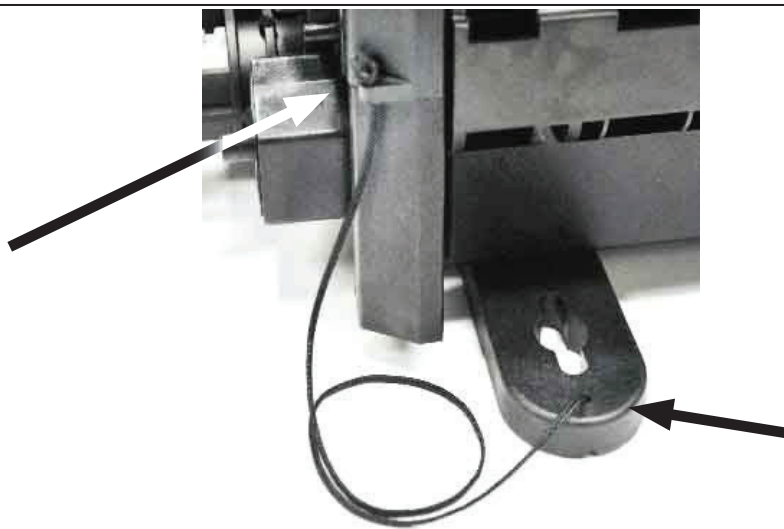

Step 1: Tie the cord on the body and on the cover to secure the cover.

13. Flash Test

max : 0,4 bar
5,8 Psi



Step 1: Remove the cap and pressurize the closure over the duration of the test. In case of any leakage, it can be located by using an appropriate detection fluid (not supplied and not shown).