

# CORNING

## Sheath Removal of RPX® Ribbon Cable-250 and RPX Long Span Ribbon Cable-250

004-115-AEN, Issue 3

related literature | Search [www.corning.com/opcomm](http://www.corning.com/opcomm). Click on "Resources/Standard Recommended Procedures."

[AEN181](#) [RPX® Gel-Free Ribbon Cable Considerations for Underground Applications](#)

[AEN155](#) [RPX Gel-Free Ribbon Cable Tutorial for Aerial Self Support Applications](#)

[Video](#) [RPX Cable End-Access with RPX2-CAT tool](#)

[Video](#) [RPX Ribbon Cable Mid-Span with RPX2-CAT Tool](#)

[Video](#) [RPX Ribbon Cable End-Access Video with MB02 Tool](#)

[Video](#) [RPX Ribbon Cable Mid-Span with MB02 Tool](#)

### 1. End-Access Using RPX2-CAT

**Step 1:** Measure access length and remove approximately 6 inches of jacket at the access point.

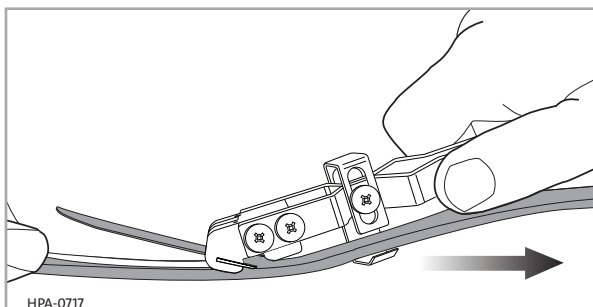

**Step 2:** Flex the cable to create a loop in the ribbons. Gently pull the ribbons and foam out of the cable.

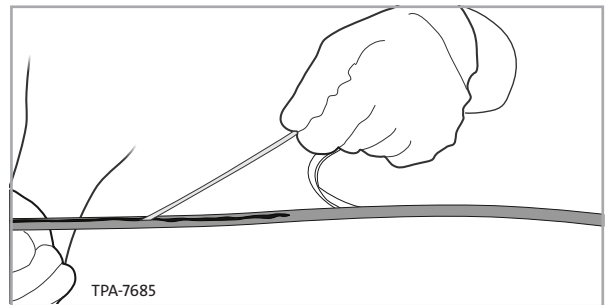

**Step 3:** Cut the jacket, GRP, and foam flush at the access point.

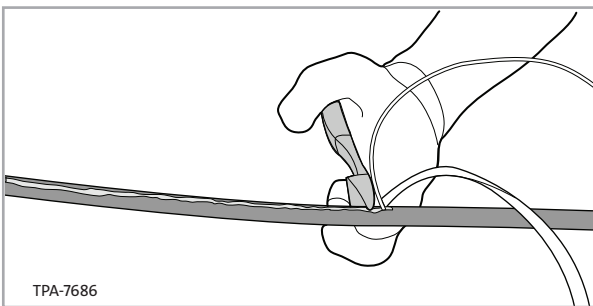

**Step 4:** Use the needle nose pliers and remove jacket and foam together.

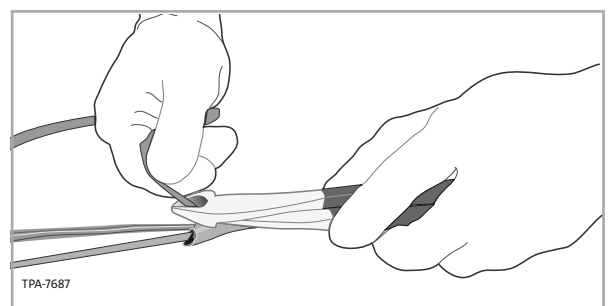

### 2. Mid-Span Access Using RPX2-CAT

**Step 1:** Adjust the tools blade angle depending on blade wear and condition of cable jacket.

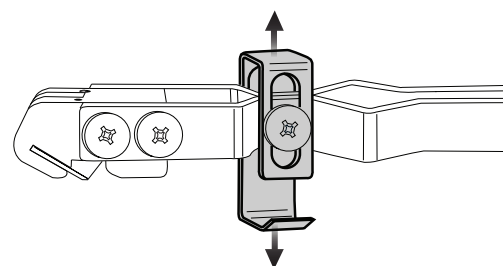
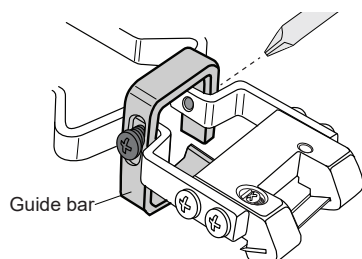

**Step 2:** Remove the jacket over the entire length required for mid-span.

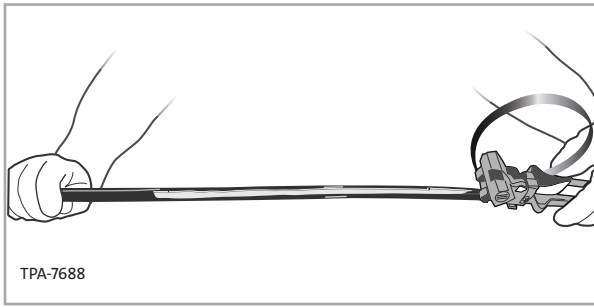

**Step 3:** Flex cable to create a loop in the ribbons and remove from the cable.



**Step 4:** Cut the jacket, strength members, and foam flush at each end of the mid-span access window.

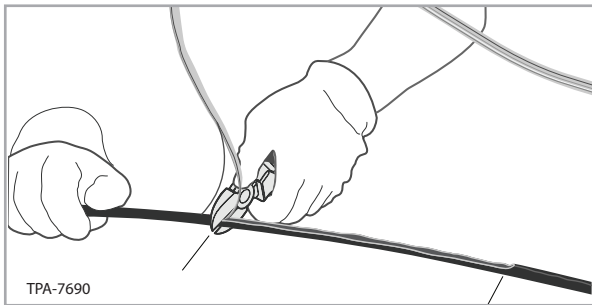

**Step 5:** Mid-span access complete.

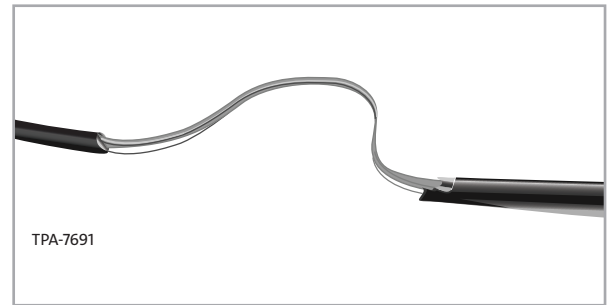

### 3. End- and Mid-Span Access Using Ripley MB02 Cable Slitter or Jonard Cable Slitting Pliers

Ripley	
MB02 Cable Slitter	
RPX Tray	MB02-7-0735190
RPX Long Span Tray	MB02-7-0735191
Replacement Blades	MB02-7500

Jonard	
RPX	CSP-RPX
RPS Long Span	CSP-RPXL
Replacement Blades	CSP-10RB

**Step 1:** Measure access length for end-or mid-span access.

**Step 2:** Place the tool over the cable and hold it closed with one hand, while holding the cable in the other hand.

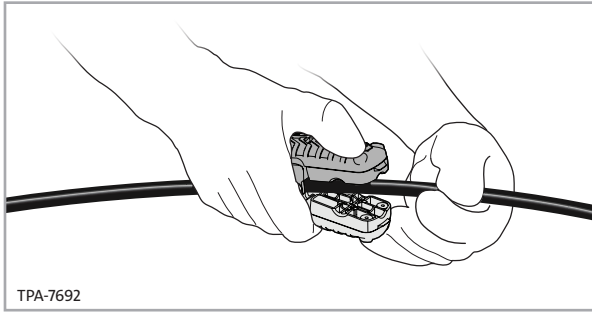

Ripley MB02

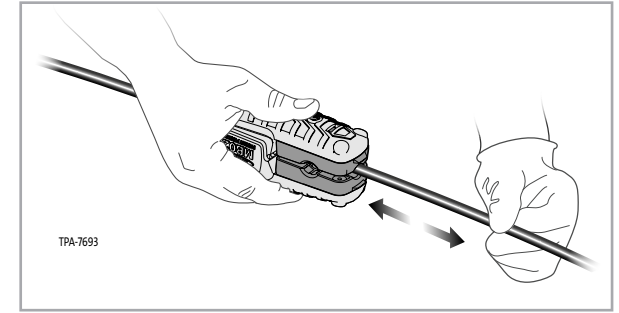

**Step 3:** Pull the tool along the end or mid-span access length.

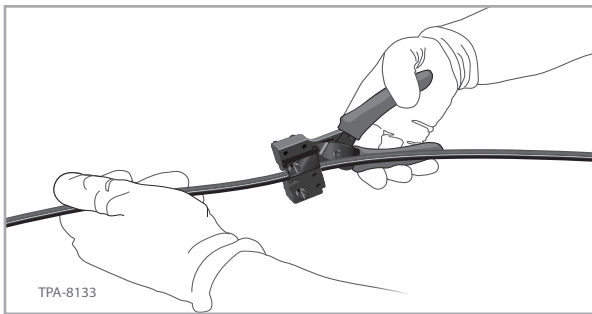

Jonard CSP

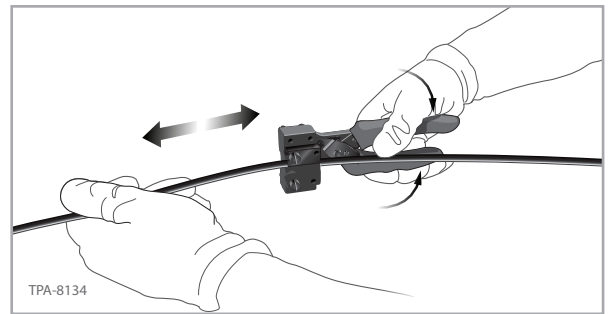

**Step 4:** Separate the jacket from the ribbons and foam.

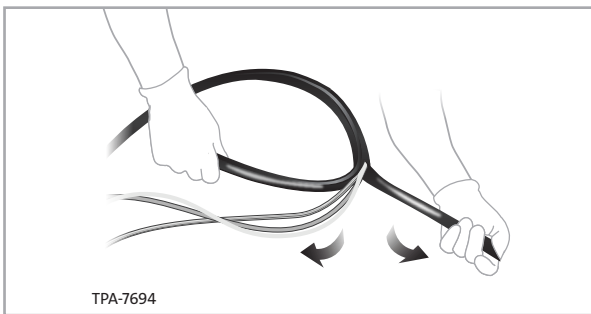

**Step 5:** Cut the jacket, foam, and strength members flush at the access point.

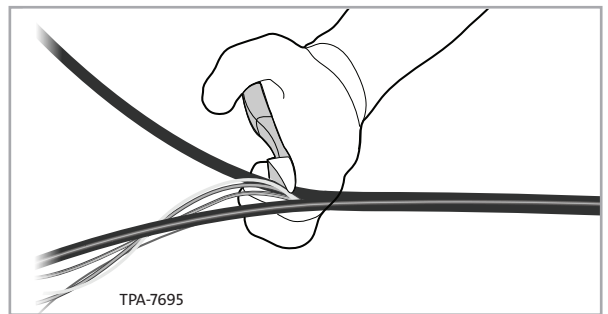

**Step 6:** Access is complete.

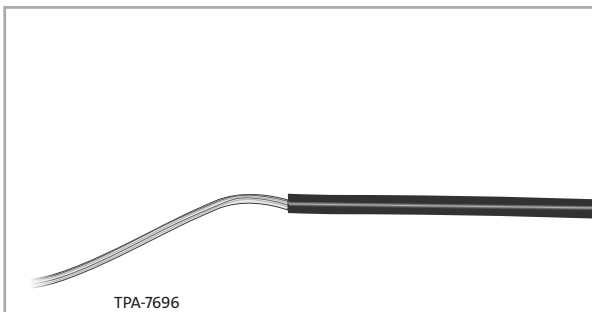

#### 4. Access of Toning Wire for RPX<sup>®</sup> Ribbon Cable-250, Toneable

**Step 1:** Adjust RPX2-CAT tool guide to the maximum adjustment.

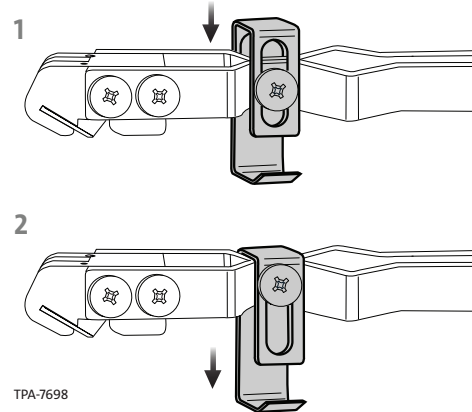
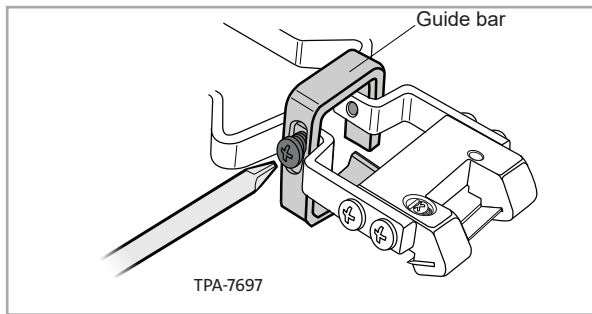

**NOTE:** *Miller MB11 or Jonard RRS-1222 can be used for this process as well.*

**Step 2:** Shave approximately 12 inches over the narrow edge of the cable on the side with the toning wire, then shave over the wide edge.

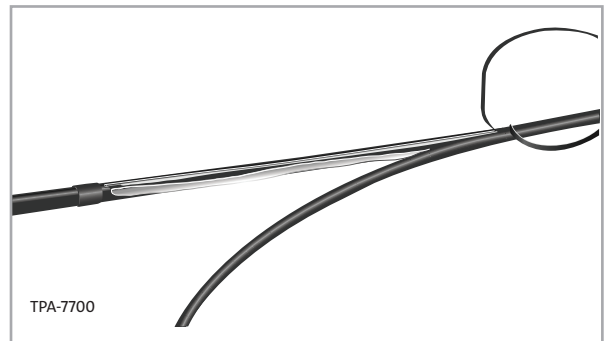
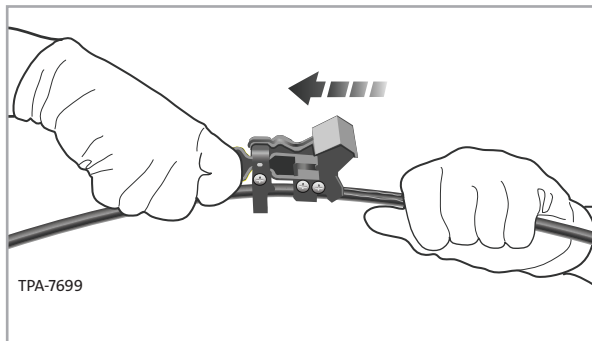

**Step 3:** Cut the jacket and strength members at the end of the 12 inch access window.

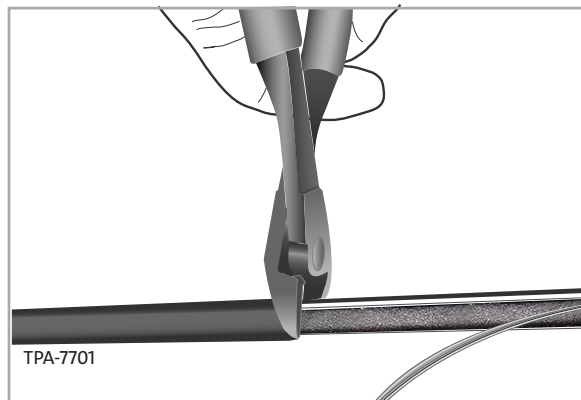

**Step 4:** Remove the wire and strength members using pliers.

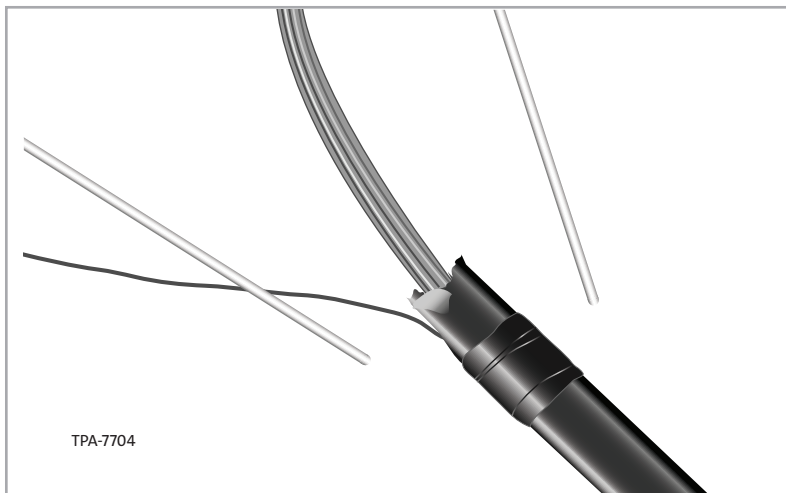
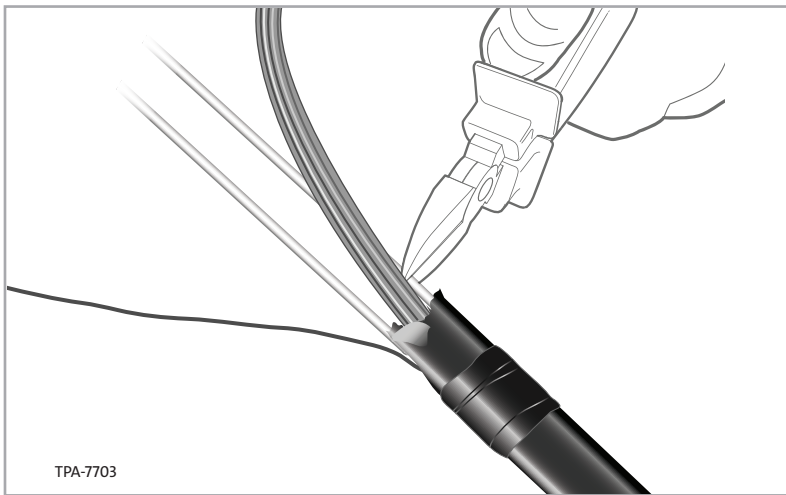
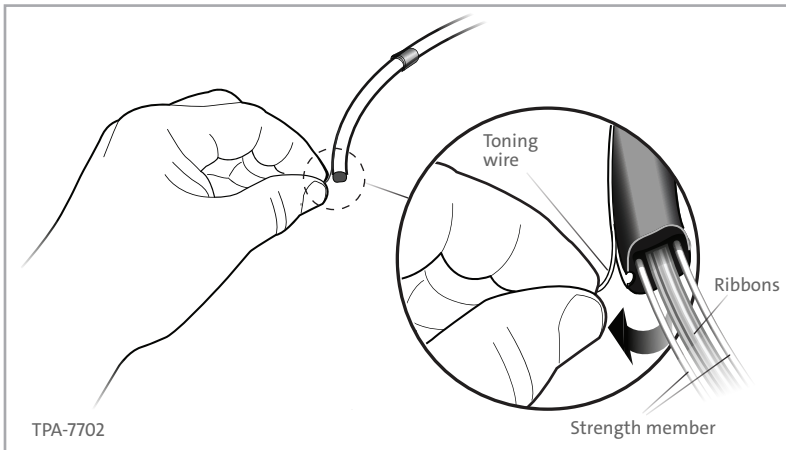

Corning Optical Communications LLC • 4200 Corning Place • Charlotte, NC 28216 USA  
800-743-2675 • FAX: 828-325-5060 • International: +1-828-901-5000 • [www.corning.com/opcomm](http://www.corning.com/opcomm)

Corning Optical Communications reserves the right to improve, enhance, and modify the features and specifications of Corning Optical Communications products without prior notification. A complete listing of the trademarks of Corning Optical Communications is available at [www.corning.com/opcomm/trademarks](http://www.corning.com/opcomm/trademarks). All other trademarks are the properties of their respective owners. Corning Optical Communications is ISO 9001 certified. © 2022, 2023, 2024 Corning Optical Communications. All rights reserved.